



### Application

- It is applicable to household water supply, equipment support, pipeline pressurization, garden watering, vegetable greenhouse watering, fish farming and poultry raising, industrial and mining, water supply and drainage of enterprises and high-rise buildings, central air conditioner and centralized heating circulation system, etc.

### Pump

- AISI 304 shaft
- Max. liquid temperature: +85°C
- Altitude: up to 1000 m
- Max. suction: 8 m
- Max. inlet pressure: limited by max. operating pressure
- Max. operation pressure: 10 bar
- Liquid PH value: 4 - 10

### Motor

- Motor with copper winding
- Built-in thermal protector for single phase motor
- Insulation class: F
- Protection class: IP55
- Max. ambient temperature: +40°C

### Identification Codes

#### ECH (m) 10 - 30



### Technical Data

Model	Power		Q (m³/h)		Q (l/min)		H		H		H	
	kW	HP	6	7	8	9	10	11	12	13	14	15
ECH(m)10-10	0.75	1.0	9.1	8.7	8.2	7.7	6.8	5.8	-			
ECH(m)10-20	1.1	1.5	17.9	17.1	16.3	15.3	14.0	12.5	10.6			
ECH(m)10-30	1.5	2.0	27.1	26.3	24.9	23.4	21.4	19.3	16.9			
ECH(m)10-40	2.2	3.0	38.6	37.6	35.9	33.9	31.2	28.2	24.6			
ECH(m)10-50	3.0	4.0	47.8	46.4	44.4	42.2	39.5	35.9	31.1			

### Dimension

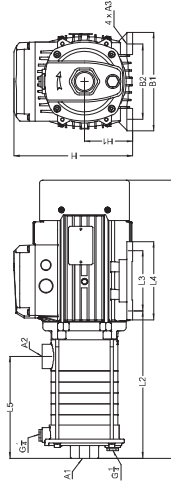

Model	L1	L2	L3	L4	L5	B1	B2	H	H1	A1	A2	A3
ECH(m)10-10	430	212	100	130	121	165	125	204.5	80	G1½	G1½	Φ10
ECH(m)10-20	430	212	100	130	121	165	125	204.5	80	G1½	G1½	Φ10
ECH(m)10-30	460.5	242.5	100	130	151.5	165	125	504.5	80	G1½	G1½	Φ10
ECH(m)10-40	549.5	261.5	125	150	182	180	140	217.5	90	G1½	G1½	Φ10
ECH(m)10-50	579.5	291.5	125	150	212	180	140	217.5	90	G1½	G1½	Φ10

### Hydraulic Performance Curves

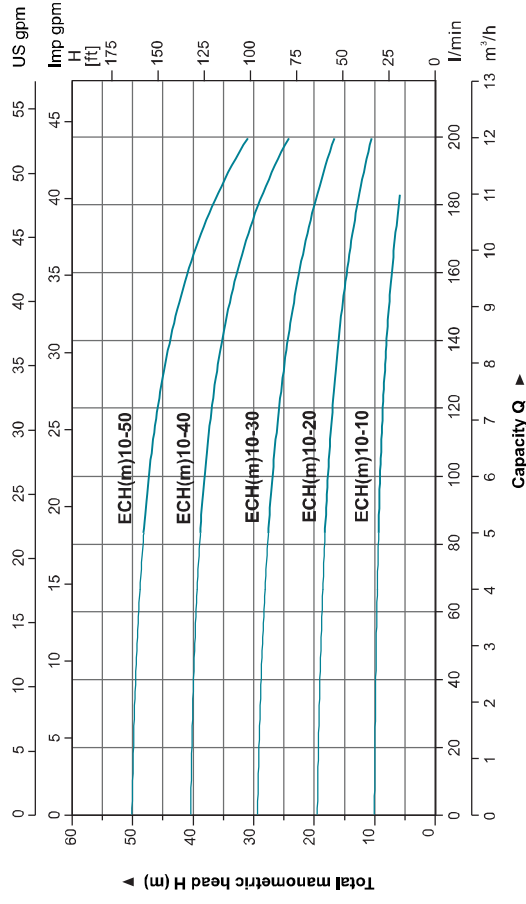

### Materials Table

No.	Part	Material
1	Fan cover	08F
2	Fan	PP
3	Rear cover	ZL102
4	Rotor	
5	Bearing	
6	Terminal box	ZL102
7	Stator	
8	Front cover	Cast iron
9	Outlet body	Cast iron
10	Mechanical seal	Carbon/Ceramic
11	Diffuser	AISI 304
12	Sleeve	AISI 304
13	Impeller	AISI 304
14	Pump body	Cast iron

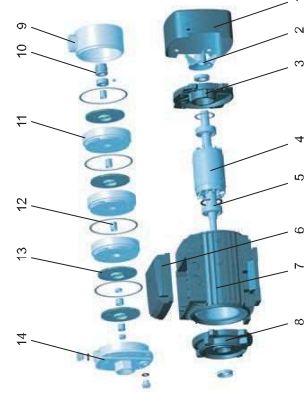

### Package Information

Model	GW (Kgs)	L (mm)	W (mm)	H (mm)	Quantity (PCS/20 TEU)
ECH(m)10-10	20.7	503	235	268	856
ECH(m)10-20	20.8	503	235	268	856
ECH(m)10-30	21.9	503	235	268	856
ECH(m)10-40	28.2	618	245	283	653
ECH(m)10-50	30.6	618	245	283	653



# ECH

## Stainless Steel Horizontal Multistage Pump



### Application

- It is applicable to household water supply, equipment support, pipeline pressurization, garden watering, vegetable greenhouse watering, fish farming and poultry raising, industrial and mining, water supply and drainage of enterprises and high-rise buildings, central air conditioner and centralized heating circulation system, etc.

### Pump

- AISI 304 shaft
- Max. liquid temperature: +85°C
- Altitude: up to 1000 m
- Max. suction: 8 m
- Max. inlet pressure: limited by max. operating pressure
- Max. operation pressure: 10 bar
- Liquid PH value: 4 - 10

### Motor

- Motor with copper winding
- Built-in thermal protector for single phase motor
- Insulation class: F
- Protection class: IP55
- Max. ambient temperature: +40°C

### Identification Codes

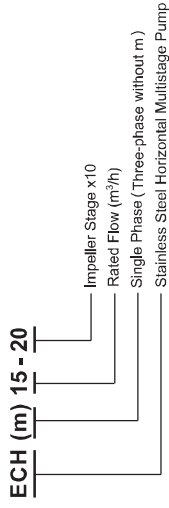

### Technical Data

Model	Power		Q (m³/h)		Q (l/min)		H (m)	
	kW	HP	9	12	15	18	21	21
ECH(m)15-10	1.1	1.5	12.4	11.6	10.6	9.4	8.2	8.2
ECH(m)15-20	2.2	3	25.6	24.1	22.7	21.1	18.8	18.8
ECH15-30	3.0	4	38.7	36.9	34.9	31.9	28.5	28.5
ECH15-40	4.0	5.5	51.8	49.7	46.8	42.9	38.3	38.3

### Dimension

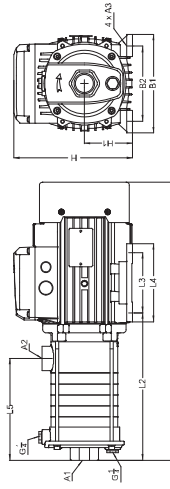

Model	L1	L2	L3	L4	L5	B1	B2	H	H1	A1	A2	A3
ECH(m)15-10	451	233.5	100	130	139.5	165	125	204.5	80	G2	G2	A3
ECH(m)15-20	510	222	125	150	139.5	180	140	217.5	90	G2	G2	Φ10
ECH15-30	560	272	125	150	189.5	180	140	247.5	90	G2	G2	Φ10
ECH15-40	616	336.5	140	180	230	205	160	224.5	100	G2	G2	Φ12

### Hydraulic Performance Curves

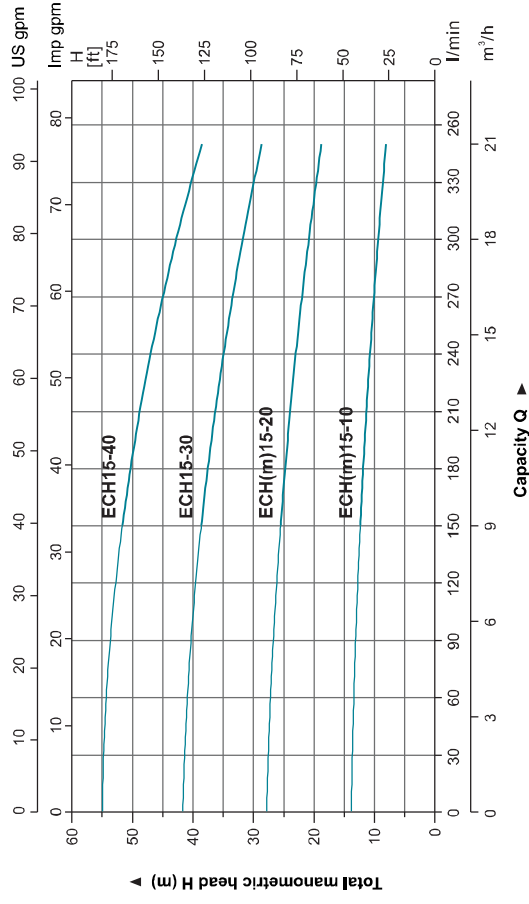

### Materials Table

No.	Part	Material
1	Fan cover	08F
2	Fan	PP
3	Rear cover	ZL102
4	Rotor	
5	Bearing	
6	Terminal box	ZL102
7	Stator	
8	Front cover	Cast Iron
9	Outlet body	Cast Iron
10	Mechanical seal	Carbon/Ceramic
11	Diffuser	AISI 304
12	Sleeve	AISI 304
13	Impeller	AISI 304
14	Pump body	Cast Iron

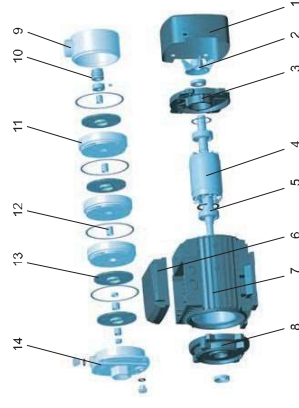

### Package Information

Model	GW (Kgs)	L (mm)	W (mm)	H (mm)	Quantity (PCS/20 TEU)
ECH(m)15-10	22.7	503	235	268	856
ECH(m)15-20	30.3	557	245	283	659
ECH15-30	32.2	618	245	283	620
ECH15-40	39.6	687	245	290	504



# ECH

## Stainless Steel Horizontal Multistage Pump



### Application

- It is applicable to household water supply, equipment support, pipeline pressurization, garden watering, vegetable greenhouse watering, fish farming and poultry raising, industrial and mining, water supply and drainage of enterprises and high-rise buildings, central air conditioner and centralized heating circulation system, etc.

### Pump

- AISI 304 shaft
- Max. liquid temperature: +85°C
- Altitude: up to 1000 m
- Max. suction: 8 m
- Max. inlet pressure: limited by max. operating pressure
- Max. operation pressure: 10 bar
- Liquid PH valve: 4 - 10

### Motor

- Motor with copper winding
- Built-in thermal protector for single phase motor
- Insulation class: F
- Protection class: IP55
- Max. ambient temperature: +40°C

### Identification Codes

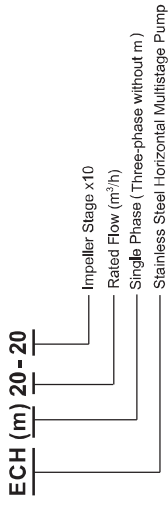

### Technical Data

Model	Power		Q (m <sup>3</sup> /h)	12	16	20	24	28
	kW	HP						
ECH(m)20-10	1.1	1.5	200	12.1	10.8	9.5	7.8	5.7
	2.2	3	26.1	24.4	22.4	19.8	17.2	
ECH(m)20-20	4.0	5.5	39.9	36.0	35.5	31.4	26.9	
			52.7	50.1	45.9	40.3	34.0	

### Dimension

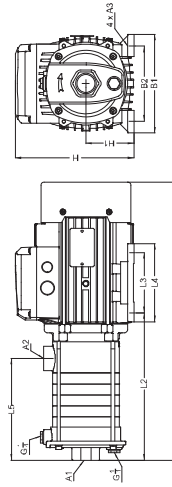

Model	L1	L2	L3	L4	L5	B1	B2	H	H1	A1	A2	A3
ECH(m)20-10	451	233.5	100	130	139.5	165	125	204.5	80	G2	G2	Φ10
ECH(m)20-20	510	222	125	150	139.5	180	140	217.5	90	G2	G2	Φ10
ECH20-30	570.5	291	140	180	184.5	205	160	224.5	100	G2	G2	Φ12
ECH20-40	616	336.5	140	180	230	205	160	224.5	100	G2	G2	Φ12

### Hydraulic Performance Curves

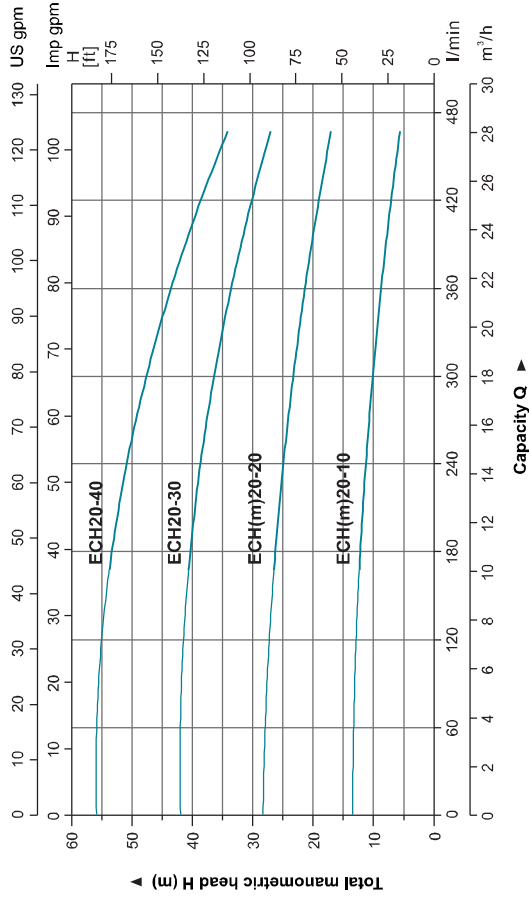

### Materials Table

No.	Part	Material
1	Fan cover	08F
2	Fan	PP
3	Rear cover	ZL102
4	Rotor	
5	Bearing	
6	Terminal box	ZL102
7	Stator	
8	Front cover	Cast Iron
9	Outlet body	Cast Iron
10	Mechanical seal	Carbon/Ceramic
11	Diffuser	AISI 304
12	Sleeve	AISI 304
13	Impeller	AISI 304
14	Pump body	Cast Iron

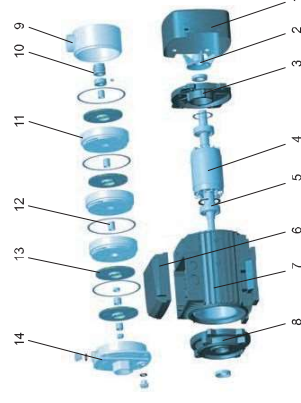

### Package Information

Model	GW (Kgs)	L (mm)	W (mm)	H (mm)	Quantity (PCS/20 TEU)
ECH(m)20-10	22.7	503	235	268	856
ECH(m)20-20	30.3	557	245	283	659
ECH20-30	38.9	667	245	290	513
ECH20-40	39.4	667	245	290	504

